

GAS LEAKAGE ALARM

USER'S MANUAL

SKETCH MAP

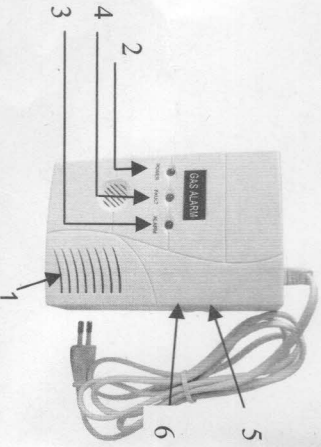

- 1---Ventilation slots
- 2---Green indicator (for power)
- 3---Red light (alarm indication)
- 4---Yellow light (Faulty indicator for sensor)
- 5---Button for power (for battery)
- 6---Test button

FEATURES

Superior gas sensor with Japan technology is adopted for this product, suitable for household. The ignitable leakage gases can be detected by the method of light/sound alarm and driving the valve to remove the danger.

- *Power Source: 220V AC with 9V back-up battery.
- * Sensitivity: 10%LEL
- * Alarm Consumption: 1.7W

- * Static Consumption: $\leq 0.5W$
- * Operating Temperature: $-10^{\circ}C \sim 50^{\circ}C$
- * Ambient Humidity: Less than 95% RH
- * Horn Level: 85 Decibels within 3m.
- * Type Of Gas Sensed:
 1. LPG (Butane, Propane) used in normal and mini gas bottles
 2. Gas from piping system (city gas) and natural gas (Methane)
- * Test button to test the units electronics and verifies proper unit operation.
- * Battery button is used to transfer power when the main power is cut off.

APPLICATION

- *Mounted on the wall or cabinet, about 30cm above the ground for LPG or about 30cm below the ceiling for coal gas and natural gas use.

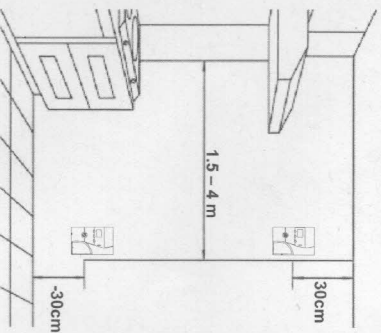

- *Ventilation hole showed as sketch should be installed down.
- *The equipment needs 3-5 minutes for starting

- up sensor. The green LED on in normal mode.
- * When the ignitable gas is detected, the red indicator shall be flashed with "di-di-di" alarm sound until the ignitable gas disappears.
- * If the sensor is invalid, the yellow indicator will be flash.

ATTENTION

- *Install firmly to avoid impact and drop;
- *Don't let dust and oil block the ventilation slots;
- *Don't install product near hot, humid and oiling sources. Don't install it near window or fan, where leakage gas can be quickly disappeared.
- *Monthly checking if equipment can work well by pushing a little gas from a cigar lighter near the ventilation slots.
- *Inform to the supplier for warranty if there's something wrong with the equipment.
- *Don't repair or dismantle by unprofessional persons.

HOW TO CONNECT BATTERY

Pull out the door of battery box on the back cover and connect the plug inside, and then the BACK-UP battery start to work.

When main power is cut off, please press the battery switch button and make it work in battery powered mode, usually the working time of battery could be more than 12 hours.

CAUTION



For your safety, you must connect back-up battery before connecting to AC power.

HOW TO DO WHEN ALARMED

- * Carefully remove all children and not relative people from that area.
- * Turn off all gas valve and gas bottle, open all doors and windows
- * Don't use electrical fans, not turning any contactors. Don't let electric sparks appear.
- * Waiting till the equipment stop alarm then checking the gas system or phone to gas supplier to verify it.
- pipe. After finalizing all errors of gas system, reset the valve by pulling out the red button.
- * If there's an auto-valve, it'll auto-close the gas

WARRANTY INFORMATION

- * 3-year limited Gas alarm warranty.
- * Company warrants to the original consumer
- * Purchaser each new gas alarm to be free from defects in material and workmanship under normal use and service for a period of 3 years from the date of purchase.
- * This warranty does not cover damage resulting from accident, misuse or abuse or lack of reasonable care of the product.

